

Soft Materials

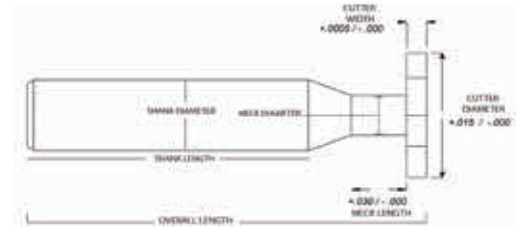

Soft Material Cutting Steel Shank Key Cutters

Cutter ø	Cutter Width	Neck ø	Neck Length	# of Teeth	Shank Length	OAL	Depth of Cut	Shank ø	Uncoated Part #
5/8	.0312 (1/32)	.280	1/4	6	2.469	2-3/4	.1725	1/2	RKC781660
	.0625 (1/16)	.280	1/4	6	2.438	2-3/4	.1725	1/2	RKC781670
	.0938 (3/32)	.280	1/4	6	2.406	2-3/4	.1725	1/2	RKC781680
	.1250 (1/8)	.280	1/4	6	2.375	2-3/4	.1725	1/2	RKC781690
	.1562 (5/32)	.280	1/4	6	2.344	2-3/4	.1725	1/2	RKC781700
	.1875 (3/16)	.280	1/4	6	2.313	2-3/4	.1725	1/2	RKC781705
	.2500 (1/4)	.280	1/4	6	2.250	2-3/4	.1725	1/2	RKC781720
3/4	.0312 (1/32)	.280	1/4	6	2.469	2-3/4	.2350	1/2	RKC781728
	.0625 (1/16)	.280	1/4	6	2.438	2-3/4	.2350	1/2	RKC781730
	.0938 (3/32)	.280	1/4	6	2.406	2-3/4	.2350	1/2	RKC781740
	.1250 (1/8)	.280	1/4	6	2.375	2-3/4	.2350	1/2	RKC781750
	.1562 (5/32)	.280	1/4	6	2.344	2-3/4	.2350	1/2	RKC781760
	.1875 (3/16)	.280	1/4	6	2.313	2-3/4	.2350	1/2	RKC781765
	.2500 (1/4)	.280	1/4	6	2.250	2-3/4	.2350	1/2	RKC781785
	.3125 (5/16)	.490	1/4	6	2.188	2-3/4	.1300	1/2	RKC781800
.3750 (3/8)	.490	1/4	6	2.125	2-3/4	.1300	1/2	RKC781810	
7/8	.0625 (1/16)	.280	1/4	6	2.438	2-3/4	.2975	1/2	RKC781813
	.1250 (1/8)	.280	1/4	6	2.375	2-3/4	.2975	1/2	RKC781815
	.1875 (3/16)	.280	1/4	6	2.313	2-3/4	.2975	1/2	RKC781825
	.2500 (1/4)	.280	1/4	6	2.250	2-3/4	.2975	1/2	RKC781835
1	.0312 (1/32)	.280	1/4	6	2.469	2-3/4	.3600	1/2	RKC781846
	.0625 (1/16)	.280	1/4	6	2.438	2-3/4	.3600	1/2	RKC781850
	.0938 (3/32)	.280	1/4	6	2.406	2-3/4	.3600	1/2	RKC781855
	.1250 (1/8)	.280	1/4	6	2.375	2-3/4	.3600	1/2	RKC781860
	.1562 (5/32)	.280	1/4	6	2.344	2-3/4	.3600	1/2	RKC781862
	.1875 (3/16)	.490	1/4	6	2.313	2-3/4	.2550	1/2	RKC781865
	.2500 (1/4)	.490	1/4	6	2.250	2-3/4	.2550	1/2	RKC781875
	.3125 (5/16)	.490	1/4	6	2.188	2-3/4	.2550	1/2	RKC781885
	.3750 (3/8)	.490	1/4	6	2.125	2-3/4	.2550	1/2	RKC781890
1-1/4	.0312 (1/32)	.280	1/4	6	2.469	2-3/4	.4850	1/2	RKC781912
	.0625 (1/16)	.280	1/4	6	2.438	2-3/4	.4850	1/2	RKC781915
	.0938 (3/32)	.280	1/4	6	2.406	2-3/4	.4850	1/2	RKC781920
	.1250 (1/8)	.280	1/4	6	2.375	2-3/4	.4850	1/2	RKC781925
	.1875 (3/16)	.490	1/4	6	2.313	2-3/4	.3800	1/2	RKC781932
	.2500 (1/4)	.490	1/4	6	2.250	2-3/4	.3800	1/2	RKC781940
	.3125 (5/16)	.490	1/4	6	2.188	2-3/4	.3800	1/2	RKC781945
	.3750 (3/8)	.490	1/4	6	2.125	2-3/4	.3800	1/2	RKC781950

Key Cutters



Speeds & Feeds page 463.